

Touch Point Light & Blind 2.0

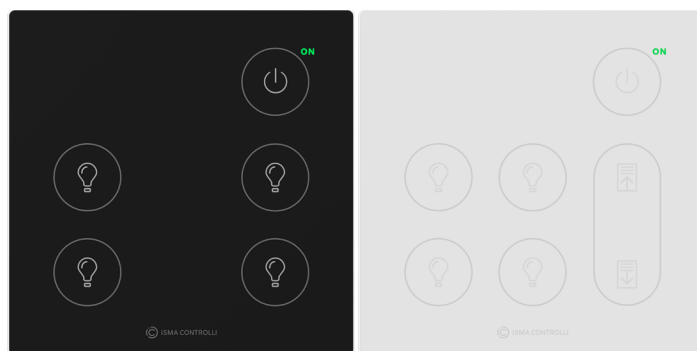

MODEL	LIGHT CONTROL	BLIND CONTROL
TP-4L-B/W-2*	•	
TP-4L1B-B/W-2*	•	•

*B/W: all panels are available in black or white, which is reflected in the B (black)/W (white) letter of the product code, e.g., TP-4L-B-2 or TP-4L-W-2.



APPLICATION AND USE

The Touch Point Light & Blind 2.0 is a modern comfort management wall panel designed for simple and efficient light and blind control, with two most popular open communication protocols: Modbus RTU/ASCII and BACnet MS/TP. Designed for intuitive operation and elegant integration into contemporary interiors, the panel provides convenient control of room automation functions in residential and commercial spaces. The Touch Point Light & Blind 2.0 is equipped with a glass front and touch control buttons. The panel can be configured using the iSMA Configurator software or Modbus registers/BACnet objects. It fits most of standard junction boxes in Europe and can easily be installed using a wall back box.

FEATURES

- Designed to fit any interior with an elegant black or pure white glass front
- Intuitive management with touch buttons
- Ease of configuration with a free iSMA Configurator app and USB-C connection
- 2 Smart Plug™ connectors, combining serial communication and power supply in a single RJ45 port
- 1 screw connector for direct RS485 and power supply
- Daisy-chain support
- Directly powered from controllers supporting Smart Plug™
- Open communication with Modbus RTU/ASCII and BACnet MS/TP, selectable with a DIP switch
- Freely configurable RGB LED
- Flush wall box 60 mm, US 1-gang electrical outlet box

TECHNICAL CHARACTERISTICS

DESCRIPTION		TOUCH POINT LIGHT & BLIND 2.0
Power supply	Voltage	DC: 20-40 VDC, AC: 24 V AC ± 20%
	Power consumption	0.6 W at 24 VDC 1.9 VA at 24 V AC
COM1	RS485 interface	Up to 128 devices Half-duplex
	Communication protocols	Modbus RTU/ ASCII, BACnet MS/TP
	Ports	2 Smart Plug RJ45 + screw connector
	Baud rate	2400-115200
USB1	Type	USB type C
Front panel	Surface	White/black glass
	Backlight	3 intensity modes
	Buttons	7 (4L1B) / 5 (4L)
	LED	1 green for occupancy 1 navigation (configurable RGB)
Ingress protection	IP rating	IP20 for indoor installation

The performances stated in this sheet can be modified without any prior notice.

DESCRIPTION		TOUCH POINT LIGHT & BLIND 2.0
Temperature	Operating	From 0°C to +40°C
	Storage	From -40°C to +70°C
Humidity	Relative	From 5% to 95% RH (without condensation)
Screw connector	Type	Removable screw terminals
	Maximum cable size	1.5 mm ² (24...16 AWG)
Housing	Material	Plastic, self-extinguishing ABS
	Mounting	Standard 60 mm wall back box
Dimensions	Width	86.00 mm/3.39 in
	Length	86.00 mm/3.39 in
	Height	14.80 mm/0.58 in

WIRING DIAGRAMS

Power Supply

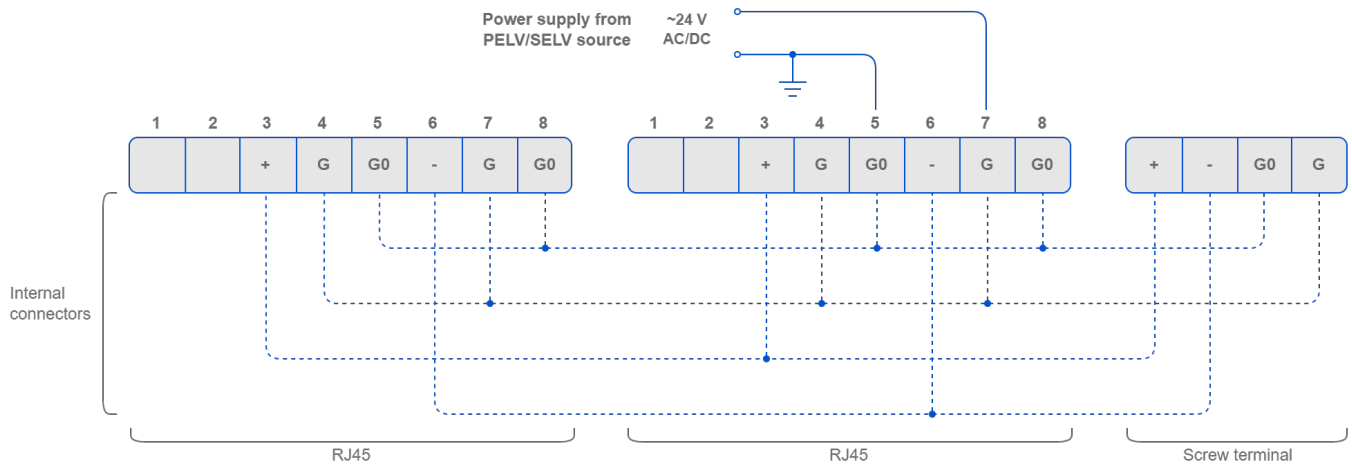
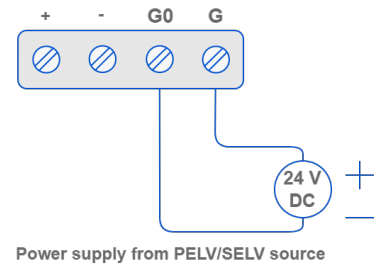
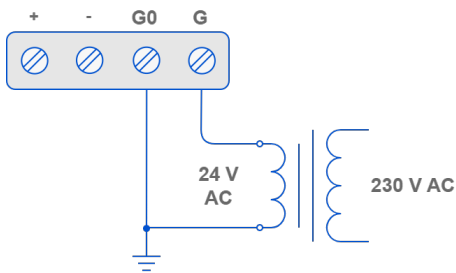

Communication

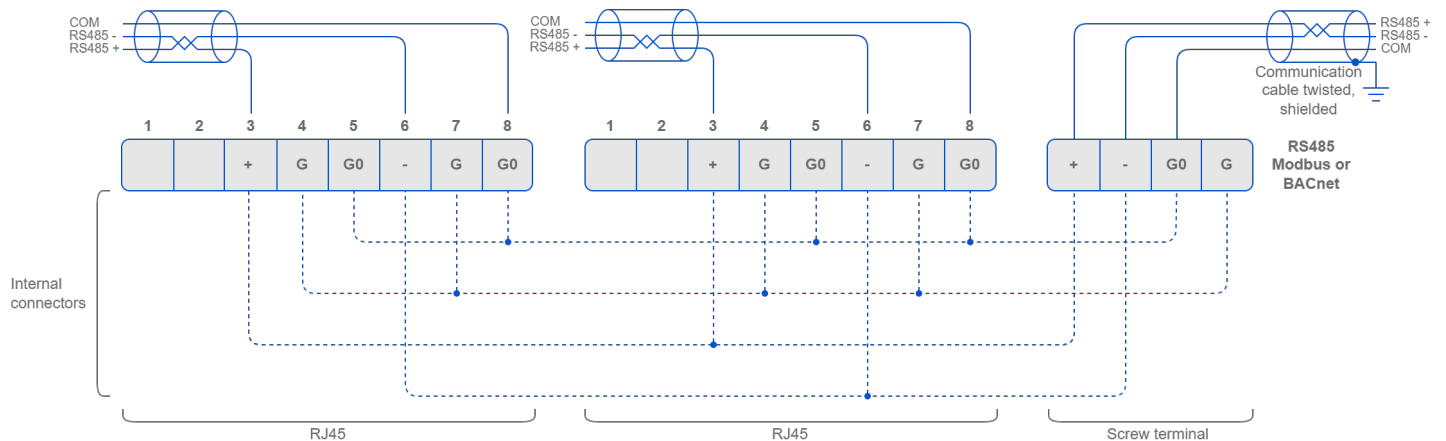

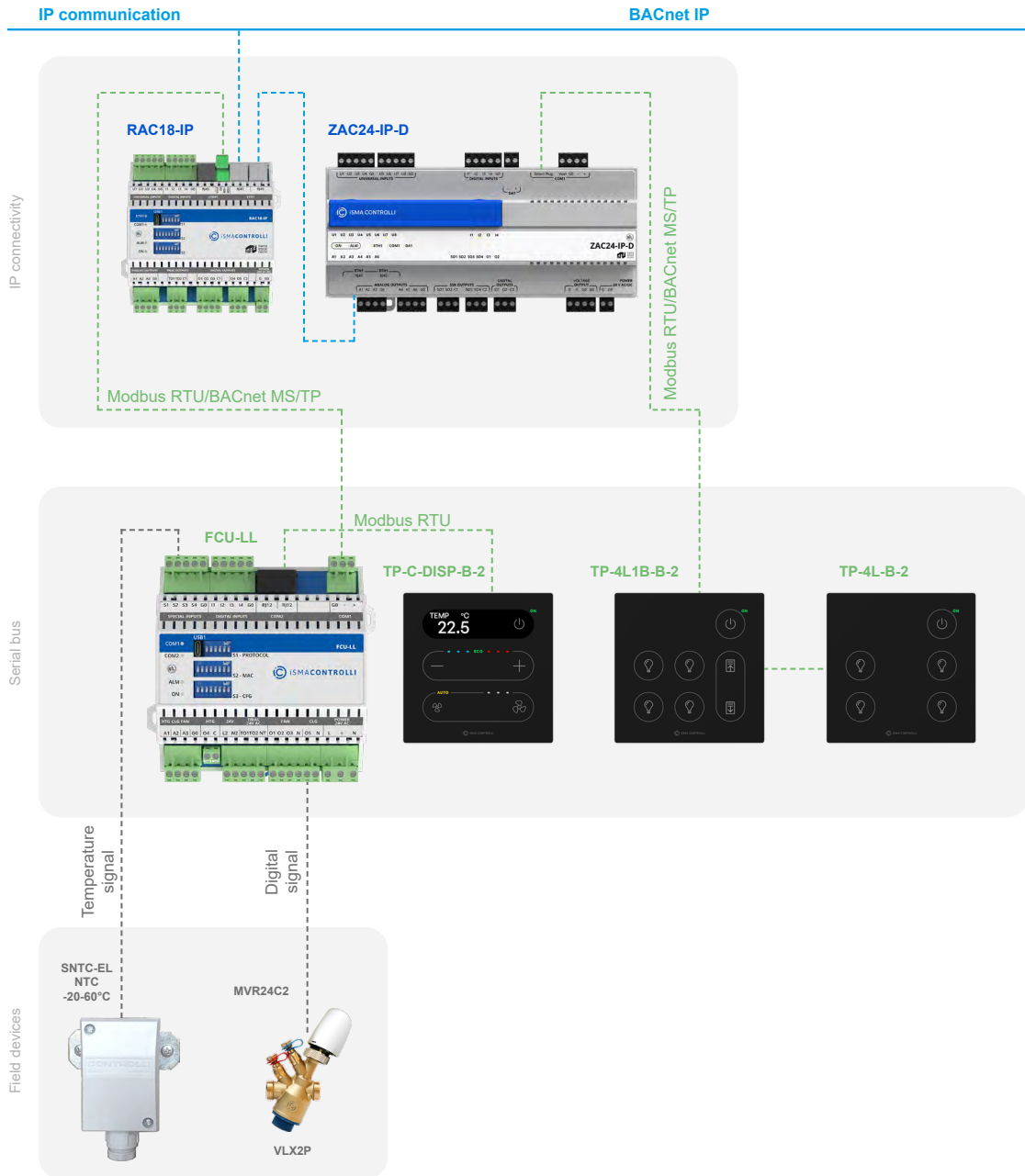

DEDICATED SOFTWARE



iSMA Configurator - configuration tool for non-programmable iSMA CONTROLLI devices

